

S-500iB™

Basic Description

The S-500iB is a six-axis, modular construction, electric servo-driven robot designed for a variety of industrial processes. The robot is engineered for precision, high-speed operation, user-friendly setup and maximum reliability. supported by our extensive service and parts network.

S-500iB, the Solution for:

- Dispensing
- Material handling
- Material removal
- Machine load/unload
- Arc welding
- Waterjet cutting
- Parts transfer

Features

- Six axes of motion
- 15 kg load capacity
- $\pm 0,15$ mm repeatability
- Axes speed up to 600 degrees per second

Reliability Features

- Grease fittings on all lubrication points for quick and easy maintenance
- RV speed reducers provide smooth motion at all speeds
- Sealed bearings and drives provide protection and improve reliability
- Interfaces with most types of servo-driven or indexing positioners
- Hollow joint construction encloses all cable routing to eliminate snagging



Perpetual Motion
FANUC
Robotics

- Brushless AC servo motors minimize motor maintenance
- Maximum speed and torque drive motors

Benefits

- Large work envelope and payload allow robot operation in a wide range of manufacturing processes
- Can operate in environments ranging from harsh to traditional factory floor
- No robot modifications for upright, inverted and wall mounting
- Absolute serial encoder positioning
- Slender arm design improves robot repeatability

Options

- *i* Pendant, a color, Internet-ready teach pendant for even easier programming
- Auxiliary axis packages for integration into part positioners.

S-500iB Dimensions

Isometric

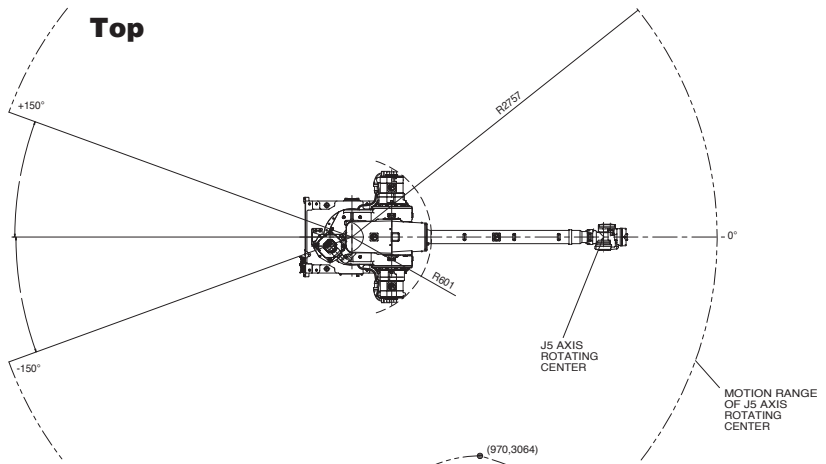
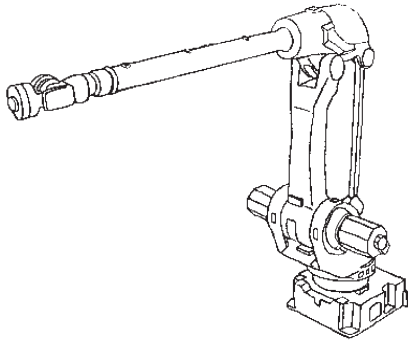

Footprint

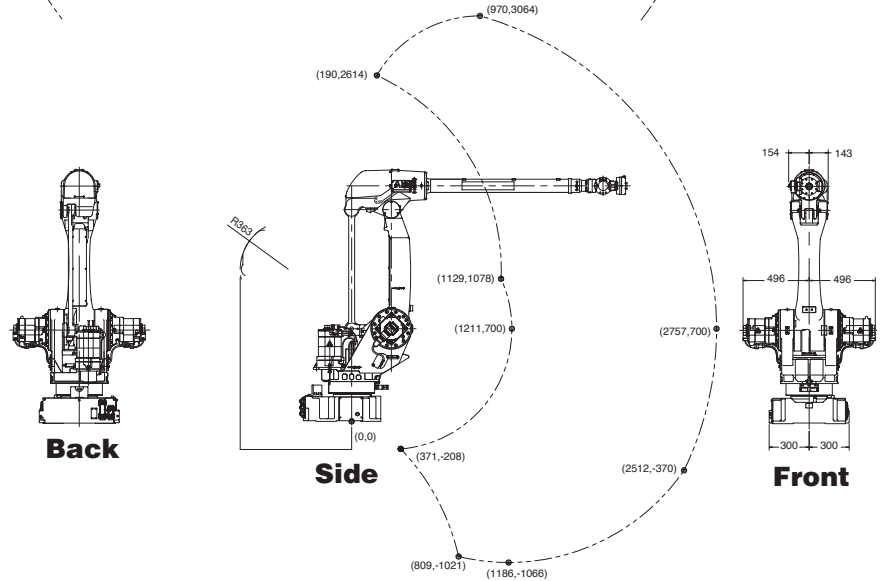
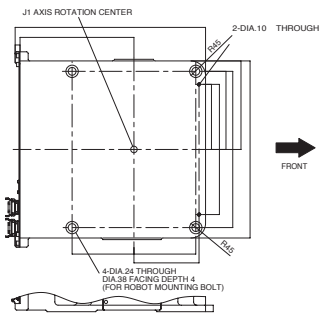

S-500iB Specifications

Items		
Configuration	articulated	
Axes	6	
Payload - wrist (kg)	15	
Reach (mm)	2557	
Static Repeatability (mm)	±0.15	
Motion range (degrees)	J1	320
	J2	160
	J3	178
	J4	480
	J5	240
	J6	900
Motion speed (degrees/sec.)	J1	170
	J2	170
	J3	200
	J4	335
	J5	360
	J6	600
Wrist moment (N·m)	J4	32,3
	J5	32,3
	J6	19,6
Wrist inertia (kg·m ²)	J4	0,73
	J5	0,73
	J6	0,26
Sealing speed (mm/sec.)	2000	
Drive Type	AC servo	
Position Encoders	Absolute	
Mechanical brakes	All axis	
Mechanical weight (kg)	610	
Mounting method	Floor, upside-down (wall & angle mount)	
Installation environment		
Ambient temperature °C	0 to 45	
Humidity	Normally: 75% or less Short term (within a month): 95% or less No condensation	
Noise	70 db or less	

Wrist

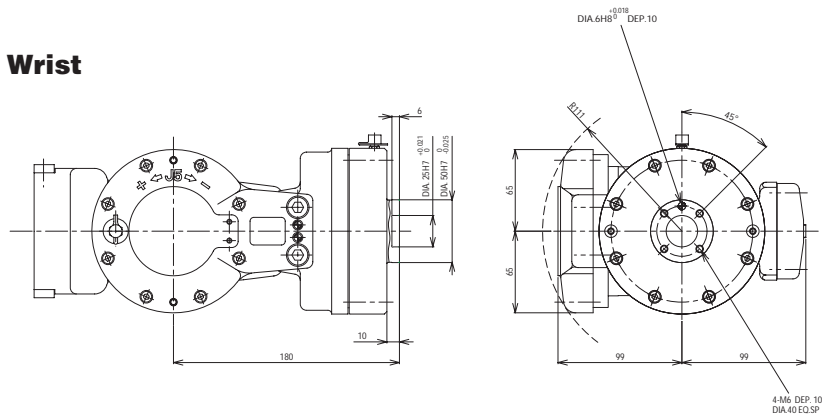

Note: Dimensions are shown in millimeters.

FANUC Robotics
Perpetual Motion

FANUC Robotics (UK) Ltd.
Seven Stars Industrial Estate
Quinn Close, Whitley
Coventry CV3 4LB

FANUC Robotics Benelux
+32-3-844-71-30

FANUC Robotics France
+33-1-69-89-7000

Tel +44 24 76 63 96 69
Fax +44 24 76 30 43 33

FANUC Robotics Germany
+49-7158187-250

FANUC Robotics Italy
+39-02-9345-601

FANUC Robotics Spain
+34-93-664-1335

www.fanucrobotics.co.uk